

Greetings all,

So here we are with the year rushing to a close and we all hope you will enjoy this last newsletter for 2009.

For those of you wanting to see past newsletters, please visit our archive at <http://www.exclusivetents.com/newsletterarchive.htm>

The [4-Rivers Floating Eco-Lodge](#) project in Cambodia is nearing completion now. Last month we were on site assisting with the setup, the site is located in a secluded bend of the Taitai River and opposite a small island in the river with lush forest on either bank.

The setup was rather challenging in that it rained incessantly the entire time we were there and even the container truck got stuck in the mud on arrival and had to be shoved out by a bull dozer.



Once on site and despite the rain, the other challenges was setting up the tents on these relatively small flexible floating modules that got overloaded at times with the weight of the tents and all the workers at the same time.

Even during the setup and challenges, one had to make sure that the modules were securely attached to the banks or to the other modules because the river current was rather strong with all the heavy rain and we had to be very careful not to let any components fall in the river which was 7m deep (23').

We believe this project to be unique in its nature and the first tented floating eco-lodge in the world and it is already getting a lot of attention and already almost fully booked prior

to opening. [4-Rivers](#) is a true eco-lodge in that its infrastructure has an almost a zero impact on the environment.



With its secluded location, pristine forest and riverine environment, this eco-lodge is going to be a unique destination for the true adventurer wanting to be in contact with nature and at the same time be living in luxury. We have just posted a [“New Projects”](#) page on the Website in which [4-Rivers Eco-Lodge](#) is the first to be featured and where more pictures can be seen.

Our Country Associate and an esteemed Architect, Patrice Belle, who is based in France and Senegal has put great effort into creating our new [Exclusive Tents Website in French](#) (only the English version is live at this moment). Together with John Evans in the UK (who is also one of our associates and a [French Property Consultant](#)), they can both assist with info and/or sales of tents in the region and both are totally fluent in French. This new website has a totally different layout and is easy to navigate; it will also be available soon with an English version.

We also have Country Associates in Turkey, Canada, Israel, Tanzania and Panama who will be happy to assist clients in these areas – ask us for their contact information.

We have a number of new tent designs that have just been put up on our [“New Tents”](#) page of the website.

This is an interesting mix of new tents in that the [Sinai Tent](#) is our first Bedouin looking tent.

The shade fly is extended and comes close to ground concealing the windows, creating a secluded, intimate romantic interior which is also perfect for massage and spa treatment rooms with the soft shaded light that is filtered from the outside.

The Shingwedzi Calf and Bateleur Chick Tents are the first of our smaller “Day Tents”.



The size of the Shingwedzi Calf is 9.3M²/100Ft² and the Bateleur Chick tents is 13.5M²/145Ft².

These Day Bed Tents are ideal for private use or on beaches, around swimming pools, spa treatment room, massage parlor, or for additional outdoor relaxing space adjoining your tent or room.

Be it for Day Bed use or for a protected social space or a garden Gazebo, these tents allow for a cozy intimate space that can be kept open or closed up selectively as one so wishes.

There are also two new mid-large sized tents we will be releasing for 2010 that are named the **Joao** and **Masbambela** Tents that are 60M²/645Ft² and 90M²/968Ft² in area respectively. These two tents will only appear on the website early next year. They are both a very practical design with the same aesthetics and are part of the Kambaku 'family of tents' with the same roof lines.

The following tents, including the Day tents, Masbambela and Joao are all part of this family of tents:

Bateleur, Kingfisher, Kambaku, Fish Eagle, Mambrrr, Dzombo, Bububu, Phelwane, Shilowa, Baobab and Futsu tents

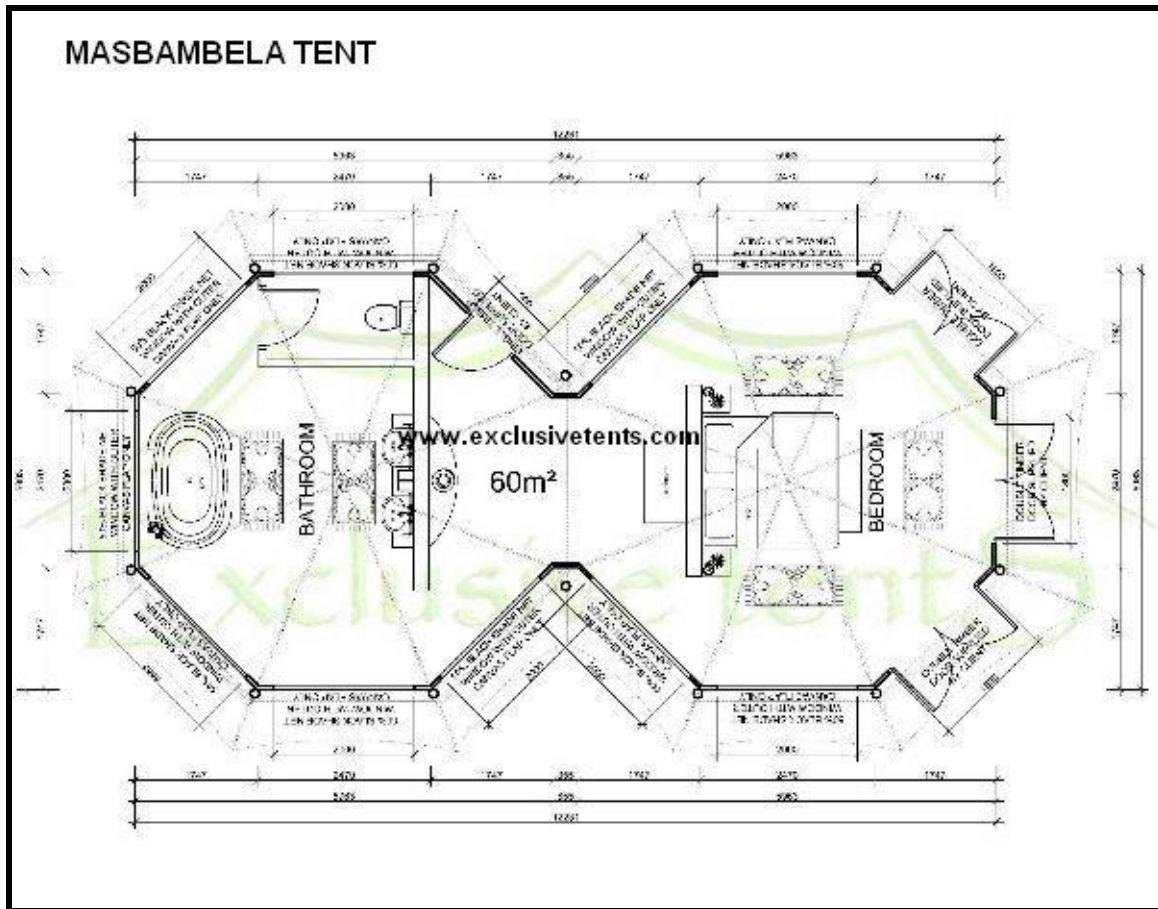

Over thirty years ago seven impressive elephant bulls, all with tusks weighing more than 50 kg each, could be found in the Kruger National Park. The Chief Warden at the time, Dr U de V Pienaar, decided to publicize these elephants as a successful example of Kruger's conservation work. He named those bulls that had not already been identified and also coined the collective name, the [Magnificent Seven](#), based on the 1960 Hollywood movie.

Most all of our tents are named in the memory of some of these [Magnificent Tuskers](#) – click on the above links to learn more about these magnificent animals and their individual histories.

With Exclusive Tents Paul Zway being a wildlife conservationist by profession and also a game ranger in the Kruger National Park for 17 years who personally knew many of these elephant individuals very well (particularly Mafunyane and Ndlulamithi (Zari), we at Exclusive Tents salute these legends and commit our tents to being as environmentally friendly as possible and make every effort to ensure that wherever they are located, they have the most minimal impact on the environment as possible.

Dr U de V Pienaar has since retired and will be shortly be releasing his new book on the Game Rangers of this era and for those interested we will update you on details of it's release in our next newsletter.

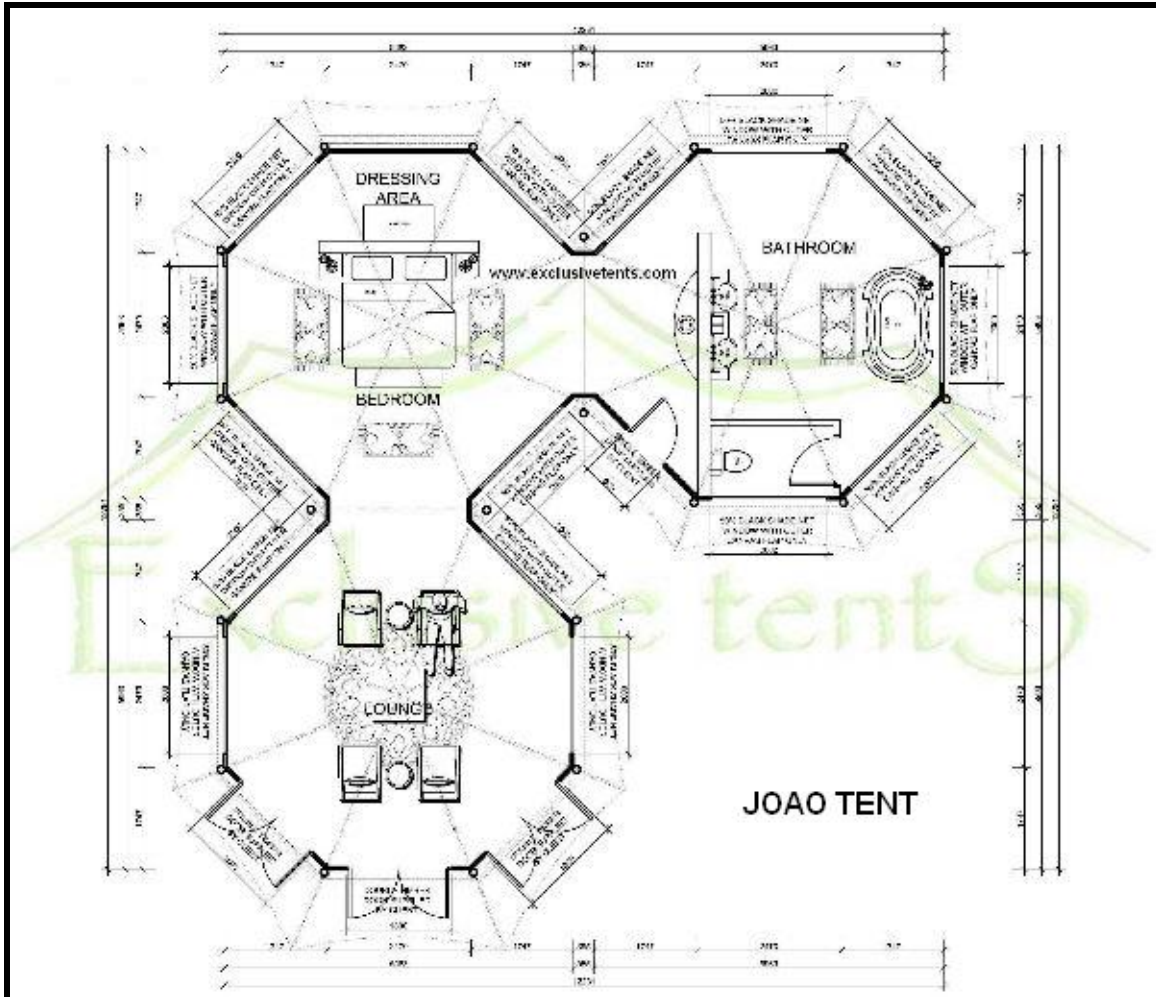

Please remember that you can follow our more regular news blurbs on [Twitter](#) so please sign up for free and “follow” our news.

Regarding stock tents, we still have a number of Serengeti and Livingston Tents available at the factory and two Serengeti’s and one Shawu tent available at the US office.

We also have a [Tent Special](#) running on 10 x 5-Leg Serengeti tents with 304 stainless steel frames available and ready to ship out at any time (except during the factory holiday period)

Any interested parties can contact anders@exclusivetents.com

This is also the time when we need to give you all the heads up that the annual factory year-end closing is from December 16th and will reopen on January 11th.

All orders taken in this period will go into production in the order received once the factory reopens.

Wish you all Happy Holidays and Seasons Greetings.

Thanks from us all at Exclusive Tents

Contacts:

Exclusive Tents: krazy@exclusivetents.com

www.exclusivetents.com

Barefoot Interiors: angelika@barefootinteriors.com

www.barefootinteriors.com

Tel: +1-520-762-9293



Exclusive Tents Locations

This world map shows some Exclusive Tent locations.

Engineered To Bring You Closer To Nature And
Allow You The Romance Of Living Under Canvas,
To Find The True Tranquility And Absolute Pure
Passion Of Life!

**To be removed from this newsletter mailing list, please send an email
from the email address you wish to have removed to
remove@exclusivetents.com with "REMOVE" in the subject line.**